

|                     |  |
|---------------------|--|
| <b>FLOOR</b>        | ALMA ELEA CARPET IN BLACK COLOR.   |
| <b>STRUCTURE</b>    | MAXIMA OCTANORM ALUMINIUM SYSTEM (H:3.50m) WITH PANELS IN WHITE COLOR AND WENGE.             |
| <b>CEILING</b>      | ALUMINIUM FRAMES 1.00x1.00 & 1.00x0.50m. IN VARIOUS HEIGHTS AND WHITE PANELS.                |
| <b>SIGN</b>         | LIGHTBOX 1.50x0.50m. WITH THE CORPORATE LOGO IN ADHESIVE VINYL _ 1PIECE.                     |
| <b>GRAPHICS</b>     | DIGITAL PRINTINGS IN FRAMED CANVAS 4.00x1.00m. _ 1PIECE & 3.00x1.00m. _ 2PIECES.             |
| <b>FURNISHING</b>   | TABLE: 1PIECE.<br>CHAIRS: 5PIECES.<br>B2B DESK: 1PIECE.<br>INFO: 2PIECES.<br>STOOL: 2PIECES. |
| <b>POWER SUPPLY</b> | 2 WAY SOCKET 500W: 2PIECES.  |
| <b>LIGHTS</b>       | LED SPOTLIGHTS 100W: 3PIECES.  |

**NOTE** Adjustment of Type 3 refers to 1, 2 & 3 open sides spaces to 48sqm. The furnishing is defined by the sq.m. of the stands as follows:

**From 12 to 23sq.m.:** infodesk 1piece, stool 1piece, B2B desk 1piece, table 1piece, chairs 5pieces.

**From 24 to 32sq.m.:** infodesk 2pieces, stools 2pieces., B2B desk 1piece, table 1piece, chairs 5pieces.

**From 33 to 48sq.m max:** infodesk 3pieces, stools 3pieces, B2B desk 2pieces, table 2pieces, chairs 10pieces.

**Power Supply / Lights:** Additional led spotlight 1 piece per 8sq.m. & 1 2way socket per 16sq.m.

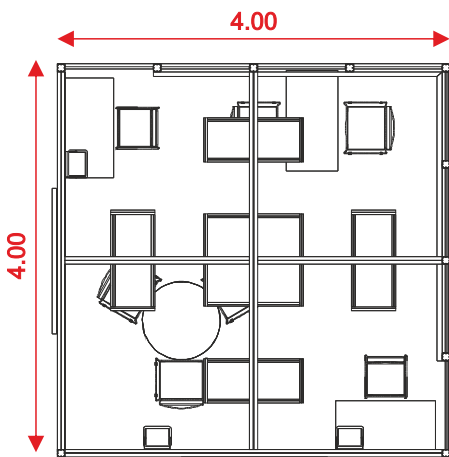

|                     |  |
|---------------------|--|
| <b>FLOOR</b>        | ALMA ELEA CARPET IN BLACK COLOR.   |
| <b>STRUCTURE</b>    | MAXIMA OCTANORM ALUMINIUM SYSTEM (H:3.50m) WITH PANELS IN WHITE COLOR AND WENGE.             |
| <b>CEILING</b>      | ALUMINIUM FRAMES 1.00x1.00 & 1.00x0.50m. IN VARIOUS HEIGHTS AND WHITE PANELS.                |
| <b>SIGN</b>         | LIGHTBOXES 1.50x0.50m. WITH THE CORPORATE LOGO IN ADHESIVE VINYL _ 2PIECES.                  |
| <b>GRAPHICS</b>     | DIGITAL PRINTINGS IN FRAMED CANVAS 3.00x1.00m. _ 2PIECES.                                    |
| <b>FURNISHING</b>   | TABLE: 1PIECE.<br>CHAIRS: 5PIECES.<br>B2B DESK: 1PIECE.<br>INFO: 2PIECES.<br>STOOL: 2PIECES. |
| <b>POWER SUPPLY</b> | 2 WAY SOCKET 500W: 2PIECES.  |
| <b>LIGHTS</b>       | LED SPOTLIGHTS 100W: 3PIECES.  |

**NOTE** Adjustment of Type 3 refers to 1, 2 & 3 open sides spaces to 48sqm. The furnishing is defined by the sq.m. of the stands as follows:

**From 12 to 23sq.m.:** infodesk 1piece, stool 1piece, B2B desk 1piece, table 1piece, chairs 5pieces.

**From 24 to 32sq.m.:** infodesk 2pieces, stools 2pieces., B2B desk 1piece, table 1piece, chairs 5pieces.

**From 33 to 48sq.m max:** infodesk 3pieces, stools 3pieces, B2B desk 2pieces, table 2pieces, chairs 10pieces.

**Power Supply / Lights:** Additional led spotlight 1 piece per 8sq.m. & 1 2way socket per 16sq.m.